

COMPRESSION COLUMN LOAD CELL FOR WEIGHBRIDGES/TRUCK SCALES

capacities 30t, 40t



This stainless steel self-centering rocker column load cell is fully welded and hermetically sealed, with protection to IP68/IP69K. It is an ideal solution for weighbridges/truck scales thanks to its approval to OIML C3 (3000 divisions), as well as in-built lightning surge arrestors and a tough, durable polyurethane cable. Anti-rotation is achieved by means of 2 flat faces on either side of the load cell base, with corresponding flat faces in the lower mounting cup.

Corner correction at the junction box is minimised because the T35 is pre-corner adjustment optimised at $\pm 0.05\%$ by output current calibration (in $\text{mV/V}/\Omega$). This saves a significant amount of time during commissioning.

For use in weighbridges/truck scales a set of zinc plated steel mounting cups, centering discs and bolts is available as an optional item.

For applications in aggressive environments where stress corrosion or acid attack could be an issue, a special Parylene coating can be specified as an option. The T35 is also available with a High Temperature option.

- Stainless steel load sensor
- Fully welded and hermetically sealed to IP68/IP69K
- In-built surge arrestors for lightning protection
- Calibrated in $\text{mV/V}/\Omega$ for pre-corner adjustment optimisation
- Simple installation
- Self-centering rocker column design with flat anti-rotation faces
- Approval to OIML R60 C3 (3000 divisions)
- Mounting cup accessories available
- High Temperature option available
- 3 year warranty

T35

technical specification...

Thames Side

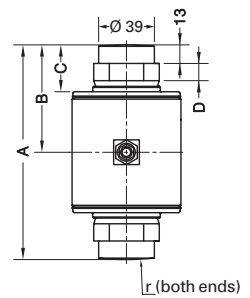
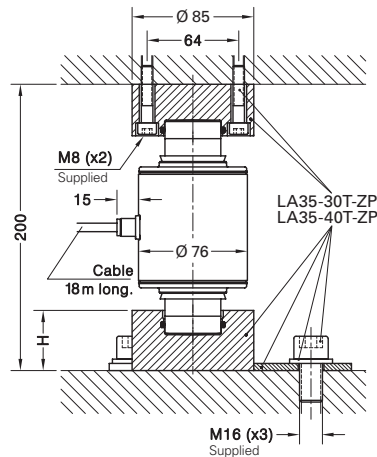
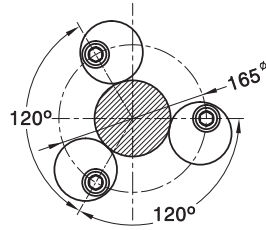
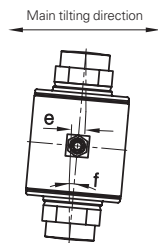

T35 Load Cell

			Load cell specification	Units
Load Cell Capacities (E _{max})			30, 40	tonnes
Rated Output (S _n)			2	mV/V *
Accuracy Class			3000	n. OIML
Combined error			< ± 0.017	% S _n
Non-repeatability			< ± 0.015	% S _n
Minimum load cell verification interval (v _{min}) = E _{max} / Y			E _{max} / 10000	tonnes
Creep (30 minutes)			< ± 0.016	% *
Temperature Effect on Zero Balance			< ± 0.002	% S _n / °C
Temperature Effect on Span			< ± 0.0012	% S _n / °C
Compensated Temperature Range			0 to +50	°C
Operating Temperature Range			-50 to +70	°C
Safe Overload			200	% E _{max}
Ultimate Overload			350	% E _{max}
Zero Balance			±2	% S _n
Input Resistance			1150	Ω ± 50
Output Resistance			1005	Ω ± 5
Insulation Resistance			> 5000	MΩ @100V
Recommended Supply Voltage			5-15	V
Maximum Supply Voltage			15	V
Environmental Protection			IP68 / IP69K	-
Maximum deflection at E _{max}			0.6 - 1	mm
Cable Length			18	m
Cable Material			Polyurethane	-
Nominal Shipping Weight	30t	Load Cell	3.4	kg
		Accessory	4.2	kg
	40t	Load Cell	3.6	kg
		Accessory	3.7	kg

* Pre-corner adjustment optimised at $\pm 0.05\%$ by output current calibration

Dimensions

Capacity	30t	40t
A	140	150
B	70	75
C	28	33
D	7	12
e max.	10.5	10
f max. permitted tilting	5°	5°
r Radius	180	235

Accessory	Dim H.
LA35-30T-ZP	52
LA35-40T-ZP	42

All dimensions are in mm

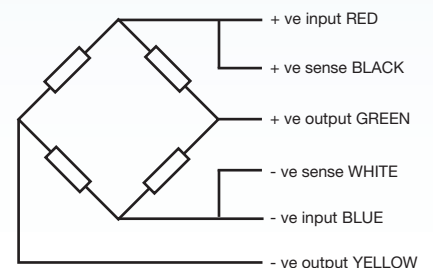

Electrical Connections

Via 6 wire, 5.7mm diameter, screened polyurethane cable.
Screen not connected electrically to load cell.

Construction

Load cell manufactured from stainless steel

Options

Mounting accessory set comprising zinc plated steel top & bottom mounting cups, centering discs, 3 off M16 bolts and 2 off M8 bolts.
Part number LA35-30T-ZP (30t capacity) or LA35-40T-ZP (40t capacity).

Thames Side Sensors India Pvt. Ltd.

A subsidiary of Thames Side Sensors Ltd. (UK)

C-6 & C-7, Hind Saurashtra Industrial Estate, Near Mittal Industrial Estate,
Marol Naka, Andheri-Kurla Road, Andheri-East, Mumbai-400 059

T: +91 22 2850 6711

E:sales@thames-side.in

www.thames-side.in

CIN U31908MH2011FTC219481



Issue: IN/T35.07.18

Our policy is one of continuous product enhancement. We therefore reserve the right to incorporate technical modifications without prior notification.



www.thames-side.in